

PROPRIETARY
 THIS DRAWING CONTAINS CONFIDENTIAL INFORMATION
 PROPRIETARY TO GMW INC. IT MUST NOT BE
 REPRODUCED OR DISCLOSED TO OTHERS OR USED IN ANY
 OTHER WAY, IN WHOLE OR IN PART EXCEPT AS AUTHORIZED
 IN WRITING BY GMW INC.

REV		DESCRIPTION	DRAFT	DATE	APPROVED
B	Added Tolerances			2/23/07	KLL

REVISIONS

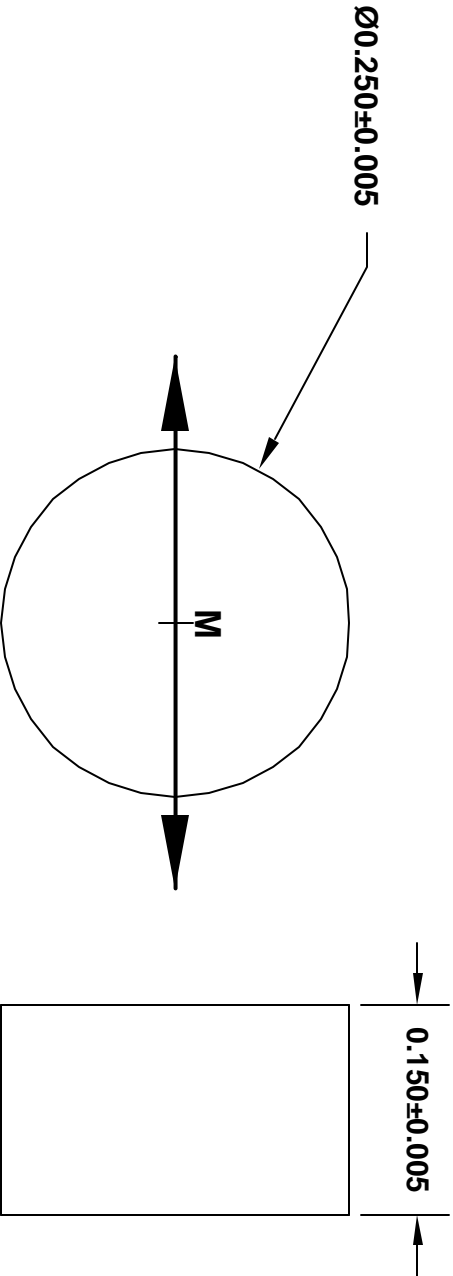

Specifications:

- 1) Parts to be magnetized in the orientation shown
- 2) Material: SmCo 24- Grade XYG26
- 3) Residual, B : 1000mT
- 4) Coercive, H: 716 KA/m
- 5) Intrinsic Coercive, H: 1432 KA/m
- 6) Maximum Energy Product: 191 KJ/m³
- 7) Parts to be Nickel plated

Source: Adams Engineered Products
 413 E Dixie Hwy
 Elizabethtown, KY 42701
 Ph: 800-763-4795
 Email: dedwards@adamsmagnetic.com
 Part Number: 55B0082

ITEM	QTY	PART NUMBER	DESCRIPTION	NOTE
PARTS LIST				
DRAWN KLL		DATE 8/15/03	DO NOT SCALE FROM DRAWING DIMENSIONS & TOLERANCES (UNLESS OTHERWISE SPECIFIED)	
CHECK		DATE		
ENGINEERING KLL		DATE 8/15/03		
		LINEAR	INCHES /	mm
		X.XXX	±.009	±0.03
		X.XX	±.07	±0.1
		X.X	±.03	±0.3
		X	±.08	±1
		DEG.	±.5	±0.5
		FINISH	83 ✓	1.B ✓
NEXT ASSY		SYSTEM	THIRD ANGLE PROJECTION	
SOFTWARE AUTOCAD 13			SCALE	WT kg
			A3	55B0082
			SHEET 1 OF 1	REV B

GMW
 P.O. Box 2578, Redwood City, CA 94064
 Tel: (650)802-8292. Fax: (650)802-8298.

TITLE
 Magnet, SmCo 24
 0.25" d x 0.15"
 Nickel plated

SIZE
 DRAWING NO.
 55B0082